







- LEGENDA**
-  CICLOVIA A IMPLANTAR
 -  CALÇADA A IMPLANTAR
 -  PISO PODOTÁTIL
 -  REBAIXO DO MEIO FIO
 -  MEIO FIO
 -  POSTE EXISTENTE
 -  BOCA DE LOBO EXISTENTE
 -  BOCA DE LOBO RELOCADA

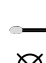
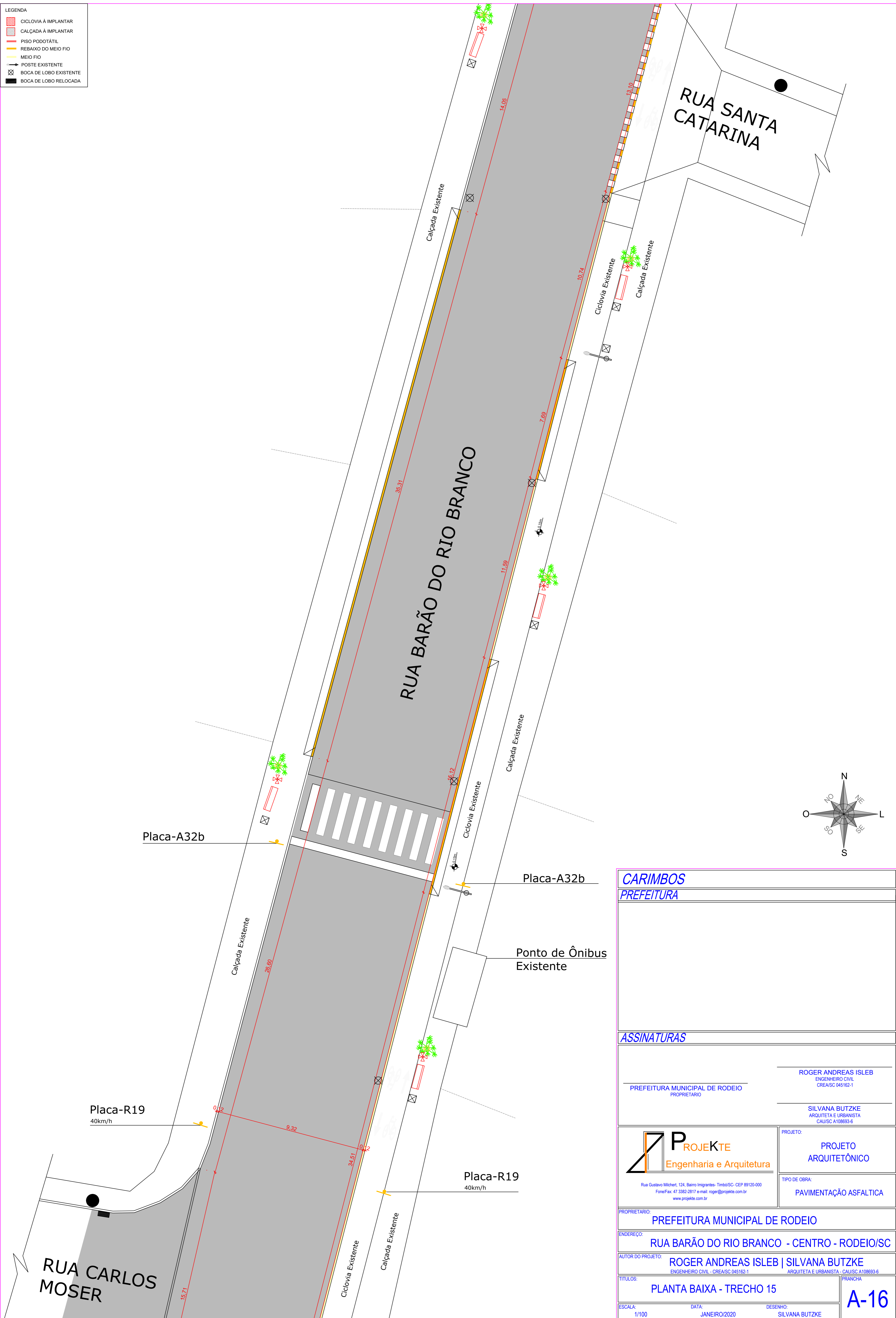

CARIMBOS	
PREFEITURA	
ASSINATURAS	
PREFEITURA MUNICIPAL DE RODEIO PROPRIETARIO	ROGER ANDREAS ISLEB ENGENHEIRO CIVIL CREA/SC 045162-1
PROJETO MUNICIPAL DE RODEIO PROPRIETARIO	SILVANA BUTZKE ARQUITETA E URBANISTA CAU/SC A108693-6
 <p style="font-size: small;">Rua Gustavo Michert, 124, Bairro Imigrantes - Timbó/SC - CEP 89120-000 Fone/Fax: 47 3382-2817 e-mail: roger@projekte.com.br www.projekte.com.br</p>	PROJETO: PROJETO ARQUITETÔNICO
TIPO DE OBRA: PAVIMENTAÇÃO ASFALTICA	
PROPRIETARIO: PREFEITURA MUNICIPAL DE RODEIO	
ENDEREÇO: RUA BARÃO DO RIO BRANCO - CENTRO - RODEIO/SC	
AUTOR DO PROJETO: ROGER ANDREAS ISLEB SILVANA BUTZKE <small>ENGENHEIRO CIVIL - CREA/SC 045162-1 ARQUITETA E URBANISTA - CAU/SC A108693-6</small>	
TITULOS: PLANTA BAIXA - TRECHO 15	PRANCHA: A-16
ESCALA: 1/100	DATA: JANEIRO/2020
DESENHO: SILVANA BUTZKE	